

Engineering Specification

Job Name _____
 Job Location _____
 Engineer _____
 Approval _____

Contractor _____
 Approval _____
 Contractor's P.O. No. _____
 Representative _____

LEAD FREE*

Series LFTWHG2
Tankless Water Heater Valves with
VersaFit™ Technology

Sizes: 3/4"

Series LFTWHG2 tankless water heater service valve kits feature a compact, versatile design to simplify the installation, maintenance and operation of tankless water heaters.

Features

- Compact, modified 1-plane design
- Field configurable hot valve
- F-NPT unions for connection to water heater
- F-NPT connection to water lines (FT models)
- Sweat connection to water lines (FS models)
- Press connection to water lines (PC models)
- Quarter-turn VersaFit™ valve with ergonomic color-coded handle and low torque operation
- Quarter-turn purge and drain valve with hose connection and tethered cap
- 3/4" pressure relief valve 150psi (-RV Models)

Materials

Body: Lead Free* copper silicon alloy
 Rotor: Glass-filled PPS
 Rotor seal: Internally Lubricated EPDM
 Rotor O-rings: Internally Lubricated EPDM

Standards

Certified to NSF/ANSI 61-G



NOTICE

The information contained herein is not intended to replace the full product installation and safety information available or the experience of a trained product installer. You are required to thoroughly read all installation instructions and product safety information before beginning the installation of this product.

NOTICE

Inquire with governing authorities for local installation requirements

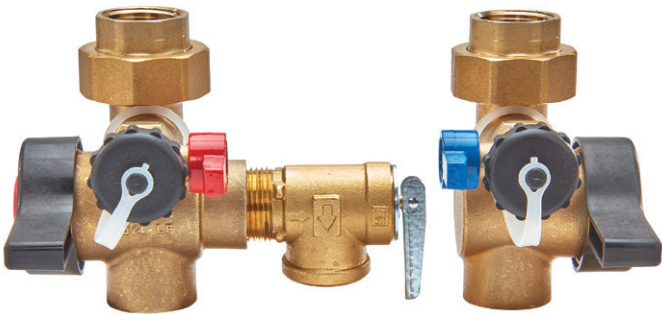

Model LFTWHG2-FT-HC-RV
 (Order Code 0120008)

Models

- All kit models include 3/4" F-NPT unions for connection to water heater
- FT models include 3/4" F-NPT connections for plumbing lines
- FS models include 3/4" female sweat connections for plumbing lines
- PC models include 3/4" press connections for plumbing lines
- RV models include 150psi (10.3 bar) ASME lead free* pressure relief valve

ORDER CODE	MODEL	PACKAGE DIMENSIONS – INCHES (MM)	PACKAGE WEIGHT
0120008	LFTWHG2-FT-HC-RV	6.9 x 5.9 x 3.5 (175 x 150 x 90)	3.1 lbs. (1.40 kgs.)
0120010	LFTWHG2-FS-HC-RV	6.9 x 5.9 x 3.5 (175 x 150 x 90)	3.1 lbs. (1.40 kgs.)
0120012	LFTWHG2-PC-HC-RV	6.9 x 5.9 x 3.5 (175 x 150 x 90)	3.1 lbs. (1.40 kgs.)

*The wetted surface of this product contacted by consumable water contains less than 0.25% of lead by weight.

Watts product specifications in U.S. customary units and metric are approximate and are provided for reference only. For precise measurements, please contact Watts Technical Service. Watts reserves the right to change or modify product design, construction, specifications, or materials without prior notice and without incurring any obligation to make such changes and modifications on Watts products previously or subsequently sold.



Dimensions

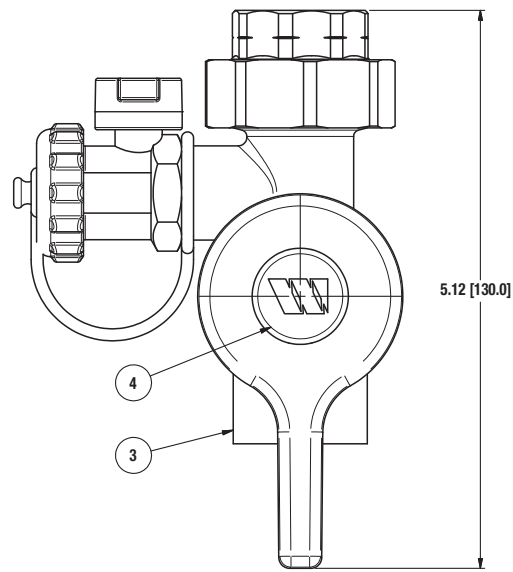
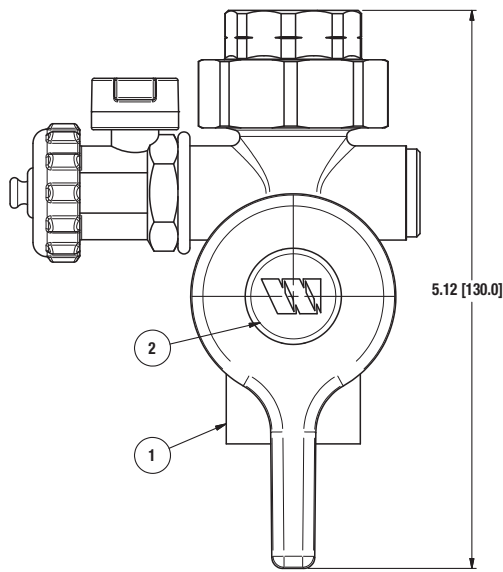
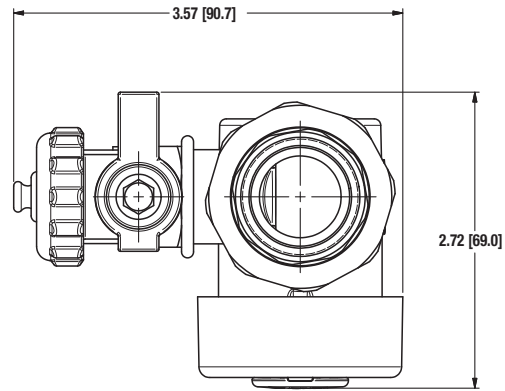
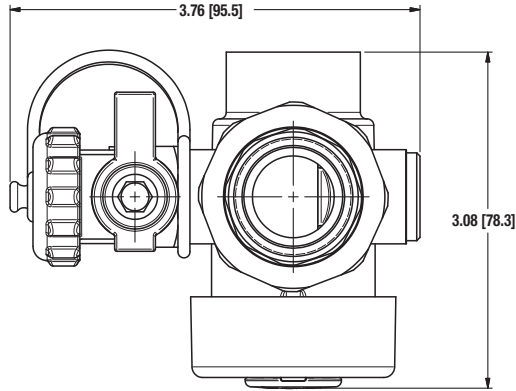

HOT SHUTOFF
SA-0.75 LFTWHG2-FT-H-RV
SEE DRAWING FOR PARTS LIST

COLD SHUTOFF
SA-0.75 LFTWHG2-FT-C
SEE DRAWING FOR PARTS LIST

Dimensions — Weights

SIZE	MODEL	CONNECTIONS	DIMENSIONS								WEIGHT	
			Height		hgt. body		Width		Depth		lbs.	kgs.
in.			in.	mm	in.	mm	in.	mm	in.	mm		
3/4"	FT-H	Union x F-NPT	5.12	130	4.00	102	3.08	78	3.76	96	1.25	0.57
3/4"	FT-H-RV	Union x F-NPT	5.12	130	4.00	102	5.37	136	3.76	96	1.65	0.75
3/4"	FT-C	Union x F-NPT	5.12	130	4.00	102	2.72	69	3.57	91	1.1	0.50
3/4"	FS-H	Union x Sweat	5.12	130	4.34	110	3.08	78	3.76	96	1.25	0.57
3/4"	FS-H-RV	Union x Sweat	5.12	130	4.34	110	5.37	136	3.76	96	1.65	0.75
3/4"	FS-C	Union x Sweat	5.12	130	4.34	110	2.72	69	3.57	91	1.1	0.50
3/4"	PC-H	Union x Press	5.12	130	4.55	116	3.08	78	3.76	96	1.25	0.57
3/4"	PC-H-RV	Union x Press	5.12	130	4.55	116	5.37	136	3.76	96	1.65	0.75
3/4"	PC-C	Union x Press	5.12	130	4.55	116	2.72	69	3.57	91	1.1	0.50



USA: T: (978) 689-6066 • F: (978) 975-8350 • Watts.com
Canada: T: (888) 208-8927 • F: (905) 481-2316 • Watts.ca
Latin America: T: (52) 55-4122-0138 • Watts.com