

Engineering Specification

Job Name _____
 Job Location _____
 Engineer _____
 Approval _____

Contractor _____
 Approval _____
 Contractor's P.O. No. _____
 Representative _____

Quick Acting Line Blinds

Models: 15A/AF, 30A/AF, 60A/AF,
 90A/AF, 150A/AF, 250A/AF

Sizes: 1"– 48"



Model 15AF

WORKING PRESSURE–NON-SHOCK

| Model | Material | Rating | Class |
|---------|--------------|-----------------|-------|
| 15A/AF | Carbon Steel | 285psi @ 100°F | 150 |
| 30A/AF | Carbon Steel | 740psi @ 100°F | 300 |
| 60A/AF | Carbon Steel | 1480psi @ 100°F | 600 |
| 90A/AF | Carbon Steel | 2220psi @ 100°F | 900 |
| 150A/AF | Carbon Steel | 3705psi @ 100°F | 1500 |
| 250A/AF | Carbon Steel | 6170psi @ 100°F | 2500 |

Type A: Butt weld | Type AF: Flanged

Typical Service

- Mueller Steam Specialty Quick Acting Line Blinds are designed for applications that require positive visual indication of line closure and opening.

Materials

- Carbon Steel bodies standard, with zinc plated carbon steel trim
- Stainless steel and other alloys available on request

Features

- Position of the spectacle plate positively and safely indicates open or closed
- O-ring seals are used for positive, dead-tight shutoff.
 - O-ring is situated in a dovetail groove on both faces.
- Stainless steel guide pins in the face of the body flange ensure accurate alignment of the spectacle plate.
- Quick and easy installation and changeover for cost savings.
 - Mueller 6" Line blind changeover can be accomplished by one operator in approximately five minutes without special tools.
 - A typical 6" Figure Eight blind typically takes two operators 1 1/2 hours to change over
- Available in flanged or weld end connections.

NOTICE

The information contained herein is not intended to replace the full product installation and safety information available or the experience of a trained product installer. You are required to thoroughly read all installation instructions and product safety information before beginning the installation of this product.

Mueller Steam Specialty product specifications in U.S. customary units and metric are approximate and are provided for reference only. For precise measurements, please contact Mueller Steam Specialty Technical Service. Mueller Steam Specialty reserves the right to change or modify product design, construction, specifications, or materials without prior notice and without incurring any obligation to make such changes and modifications on Mueller Steam Specialty products previously or subsequently sold.

Mueller Steam Specialty™

A WATTS Brand

Dimensions and Weights

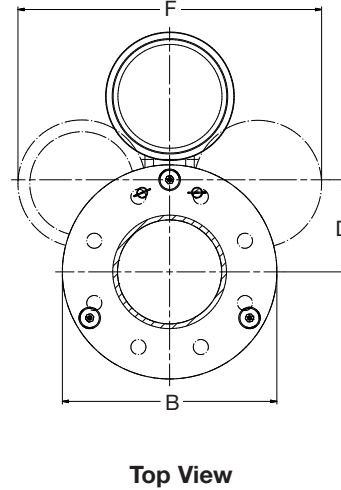
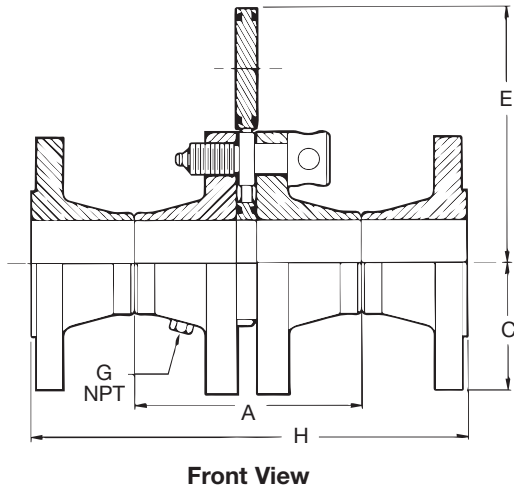

Model 15A/AF

| SIZE | DIMENSIONS | | | | | | | | | | | | WEIGHT | | | | | | | |
|-------------------------------|--------------------------------|-----|--------------------------------|-----|--------------------------------|-----|---------------------------------|-----|----------------------------------|------|--------------------------------|------|---------|----|----------------------------------|-----|------|------|------|------|
| | A | | B | | C | | D | | E | | F | | G (NPT) | | H | | 15A | | 15AF | |
| in. | in. | mm | in. | mm | in. | mm | in. | mm | in. | mm | in. | mm | in. | mm | in. | mm | lbs. | kgs. | lbs. | kgs. |
| 1 | 5 ¹ / ₈ | 130 | 4 ⁷ / ₈ | 124 | 2 ¹ / ₈ | 54 | 1 ¹⁵ / ₁₆ | 49 | 4 ¹³ / ₁₆ | 122 | 5 ³ / ₄ | 146 | NA | – | 9 ¹ / ₁₆ | 246 | 11 | 5.0 | 17 | 7.7 |
| 1 ¹ / ₂ | 5 ⁵ / ₈ | 143 | 6 ¹ / ₈ | 156 | 2 ¹ / ₂ | 64 | 2 ⁵ / ₈ | 67 | 6 | 152 | 7 ¹ / ₄ | 184 | NA | – | 10 ¹ / ₁₆ | 271 | 17 | 7.7 | 25 | 11.4 |
| 2 | 5 ³ / ₄ | 146 | 6 ¹ / ₂ | 165 | 3 | 76 | 2 ¹⁵ / ₃₂ | 63 | 6 ³ / ₈ | 162 | 7 ¹ / ₁₆ | 198 | 1/4 | 8 | 10 ¹⁵ / ₁₆ | 271 | 22 | 10 | 34 | 15.5 |
| 2 ¹ / ₂ | 6 ¹ / ₄ | 159 | 7 ¹ / ₂ | 191 | 3 ¹ / ₂ | 89 | 3 ³ / ₃₂ | 79 | 7 ⁷ / ₁₆ | 189 | 9 | 229 | 1/4 | 8 | 11 ¹⁵ / ₁₆ | 303 | 29 | 13 | 45 | 20.5 |
| 3 | 6 ¹ / ₂ | 165 | 8 ¹ / ₄ | 210 | 3 ³ / ₄ | 95 | 3 ⁷ / ₁₆ | 87 | 8 ⁵ / ₈ | 219 | 10 ⁵ / ₈ | 270 | 1/4 | 8 | 12 ³ / ₁₆ | 310 | 35 | 16 | 55 | 25 |
| 4 | 7 | 178 | 10 | 254 | 4 ¹ / ₂ | 115 | 4 ³ / ₁₆ | 106 | 10 ¹ / ₂ | 267 | 13 | 330 | 1/4 | 8 | 13 ³ / ₁₆ | 310 | 62 | 28 | 92 | 42 |
| 5 | 8 | 203 | 11 | 280 | 5 | 127 | 4 ⁵ / ₈ | 118 | 12 | 305 | 15 | 381 | 1/4 | 8 | 14 ³ / ₁₆ | 360 | 77 | 35 | 115 | 52 |
| 6 | 8 ¹ / ₈ | 206 | 12 ¹ / ₂ | 318 | 5 ¹ / ₂ | 140 | 5 ³ / ₈ | 137 | 13 ⁷ / ₈ | 352 | 17 ¹ / ₂ | 445 | 1/2 | 15 | 15 ⁵ / ₁₆ | 389 | 101 | 46 | 159 | 72 |
| 8 | 9 ¹ / ₈ | 232 | 15 | 381 | 6 ³ / ₄ | 171 | 6 ⁵ / ₈ | 168 | 16 ¹⁵ / ₁₆ | 430 | 21 ³ / ₈ | 543 | 1/2 | 15 | 17 ⁹ / ₁₆ | 440 | 159 | 72 | 237 | 108 |
| 10 | 9 ⁵ / ₈ | 245 | 17 ¹ / ₂ | 445 | 8 | 203 | 7 ⁵ / ₈ | 194 | 20 ³ / ₈ | 518 | 26 | 660 | 1/2 | 15 | 17 ¹³ / ₁₆ | 452 | 220 | 100 | 324 | 147 |
| 12 | 10 ³ / ₄ | 273 | 20 ¹ / ₂ | 521 | 9 ¹ / ₂ | 241 | 9 ¹ / ₈ | 232 | 25 ¹ / ₄ | 641 | 32 ¹ / ₄ | 819 | 1/2 | 15 | 19 ¹⁵ / ₁₆ | 506 | 339 | 154 | 559 | 254 |
| 14 | 11 ³ / ₄ | 298 | 23 | 584 | 10 ¹ / ₂ | 267 | 10 ¹ / ₄ | 260 | 28 ¹ / ₃₂ | 720 | 36 ¹ / ₄ | 920 | 1 | 25 | 21 ¹⁵ / ₁₆ | 557 | 437 | 198 | 657 | 298 |
| 16 | 12 ¹ / ₈ | 308 | 25 ¹ / ₂ | 648 | 11 ³ / ₄ | 299 | 11 ¹ / ₄ | 286 | 30 ³ / ₃₂ | 765 | 38 ¹ / ₂ | 978 | 1 | 25 | 22 ⁵ / ₁₆ | 567 | 597 | 271 | 877 | 398 |
| 18 | 13 ³ / ₄ | 337 | 28 | 711 | 12 ¹ / ₂ | 318 | 12 ³ / ₄ | 324 | 34 ¹ / ₁₆ | 865 | 43 ⁵ / ₈ | 1108 | 1 | 25 | 24 ⁷ / ₁₆ | 621 | 787 | 357 | 1087 | 493 |
| 20 | 13 ⁵ / ₈ | 346 | 30 ¹ / ₂ | 775 | 13 ³ / ₄ | 350 | 13 ³ / ₄ | 350 | 37 ⁹ / ₁₆ | 948 | 47 ⁷ / ₈ | 1216 | 1 | 25 | 25 ³ / ₁₆ | 640 | 997 | 452 | 1357 | 615 |
| 24 | 14 ³ / ₈ | 365 | 36 | 915 | 16 | 407 | 15 ¹ / ₂ | 394 | 44 ³ / ₁₆ | 1122 | 56 ³ / ₄ | 1441 | 1 | 25 | 26 ⁹ / ₁₆ | 675 | 1471 | 667 | 1990 | 903 |

Approximate dimensions for models 15A and 15AF (Class 150 only)

Larger sizes available. Consult factory for dimensions for models 30A/AF, 60A/AF, 90A/AF, 150A/AF, 250A/AF.

Limited Warranty: Mueller Steam Specialty warrants each product to be free from defects in material and workmanship under normal usage for a period of one year from the date of original shipment. In the event of such defects within the warranty period, the Company will, at its option, replace or recondition the product without charge. This shall constitute the sole and exclusive remedy for breach of warranty, and the Company shall not be responsible for any incidental, special or consequential damages, including without limitation, lost profits or the cost of repairing or replacing other property which is damaged if this product does not work properly, other costs resulting from labor charges, delays, vandalism, negligence, fouling caused by foreign material, damage from adverse water conditions, chemical, or any other circumstances over which the Company has no control. This warranty shall be invalidated by any abuse, misuse, misapplication or improper installation of the product. **THIS WARRANTY IS IN LIEU OF ALL OTHER WARRANTIES, EXPRESS OR IMPLIED, INCLUDING ANY IMPLIED WARRANTIES OF MERCHANTABILITY OR FITNESS FOR A PARTICULAR PURPOSE.** Any implied warranties that are imposed by law are limited in duration to one year.

Some States do not allow limitations on how long an implied warranty lasts, and some States do not allow the exclusion or limitation of incidental or consequential damages. Therefore the above limitations may not apply to you. This Limited Warranty gives you specific legal rights, and you may have other rights that vary from State to State. You should consult applicable state laws to determine your rights.



A WATTS Brand

USA: T: (800) 334-6259 • F: (800) 421-6772 • MuellerSteam.com

Latin America: T: (52) 55-4122-0138 • MuellerSteam.com