

POWERS

A WATTS INDUSTRIES CO.

INSTALLATION INSTRUCTIONS

ABS LEVER HANDLE KIT #900-103
For Biltmore 905 Valves**KIT CONTENTS**

ITEM	DESCRIPTION	PART NO.
C	ABS Lever Handle	900-091
--	8-32 x 5/8 Handle Screw	800-164
--	ABS Lever Handle Plug Button	900-096
D	Maximum Temperature Limit Stop (Handle Insert)	900-092

TO INSTALL

- To install dial gasket, peel backing off dial gasket (A) and attach to inside of dial plate (B). Press fit dial gasket into groove, leaving gap at bottom for drainage.
- Attach dial assembly to mixer body with screws as supplied (see Figure 1).
- Install handle (C) with lever in the downward (six o'clock) "OFF" position. (Note: Handle is factory preset for maximum HOT water discharge. When looking inside the handle, dot on temperature limit stop insert (D) is aligned with dot in molded handle stop (see Figure 2).

MAXIMUM TEMPERATURE SETTING/HANDLE ROTATION STOP

- Maximum temperature setting adjustment (see Figure 2) must be set on the job to in no case greater than 46°C [115°F]. The maximum temperature limit stop (D) is located in the handle (C). Turn handle counterclockwise to full hot position. [At full hot position, the maximum temperature limit stop (D) will rest against the stop (E).]

If the flowing water temperature is below the desired setpoint: Remove handle and, while looking inside the handle, turn maximum temperature limit stop (D) clockwise.

If the flowing water temperature is above the desired setpoint: Remove handle and, while looking inside the handle, turn maximum temperature limit stop (D) counterclockwise.

CALIFORNIA PROPOSITION 65 WARNING

WARNING: This product contains chemicals known to the State of California to cause cancer and birth defects or other reproductive harm. (Installer: California law requires that this warning be given to the consumer.)

For more information: www.wattsind.com/prop65

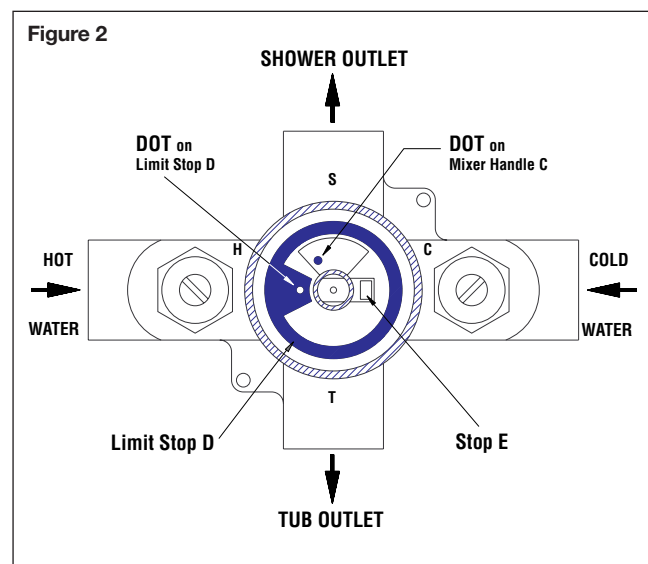
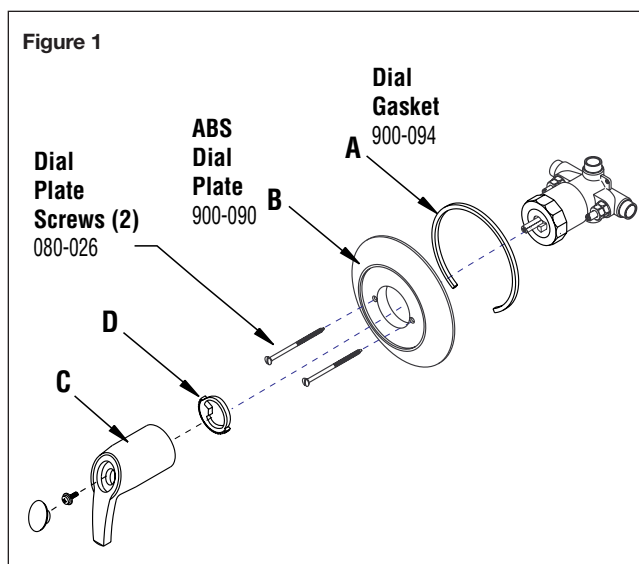

Note: For complete information on Series 900 valve installation, refer to instruction sheet enclosed with valve.

POWERS

A WATTS INDUSTRIES CO.

© Reprinted April 2001 Powers, a Watts Industries Co.

3400 Oakton Street, Skokie, IL 60076 Phone: 800.669.5430 • 847.673.6700 • Fax: 847.673.9044

www.powerscontrols.com

5435 North Service Road, Burlington, Ontario, L7L 5H7 Canada • Phone: 888.208.8927 • Fax: 888.882.1979