



Accessories



Replaces: New

## 1. Login to Router Setup

- Open web browser
- Open router setup page
- Often located at: 192.168.0.1 or 192.168.1.1
- Consult router manual or locate information on router identification sticker



Setup	Setup	Wireless	Security	Access Restrictions	Applications & Gaming
	Basic Setup	DDNS	MAC Address Clone		

Network Setup	
Router IP	Local IP Address: 192 . 168 . 0 . 1 Subnet Mask: 255.255.255.0
Network Address Server Settings (DHCP)	<div style="border: 2px solid red; padding: 5px;">                     DHCP Server: <input checked="" type="radio"/> Enable <input type="radio"/> Disable                      Starting IP Address: 192.168.0.10                      Maximum Number of DHCP Users: 50                 </div>

DHCP

- Set the DHCP range to start at address 10

Applications & Gaming	Wireless-G Broad			
	Setup	Wireless	Security	Access Restrictions
Port Range Forward	Port Range Forward	Port Triggering	DMZ	QoS

  

Port Range					
Application	Start	End	Protocol	IP Address	Enable
tekmar	80	to 80	Both	192.168.0.2	<input checked="" type="checkbox"/>

Port Forwarding or NAT

- Forward to 485 LAN static IP address example 192.168.0.2
- Internal port 80
- External port 80

## 2. Remove cover

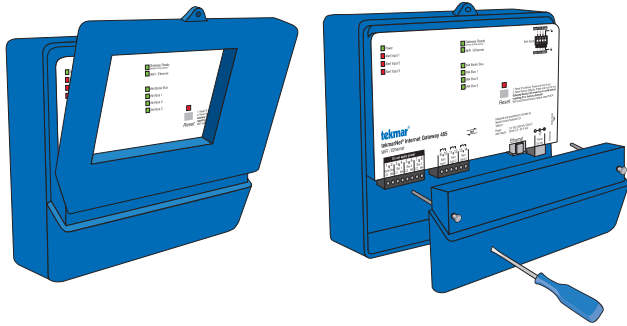

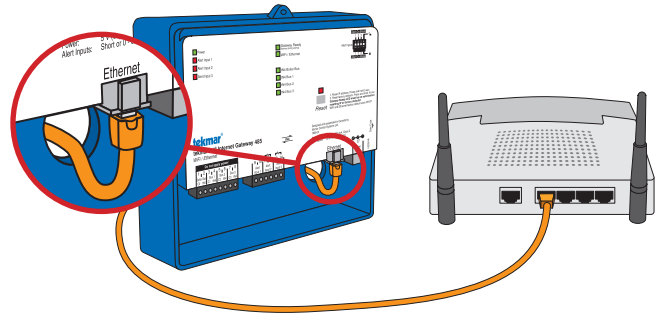

## 3. Connect Cable to Router

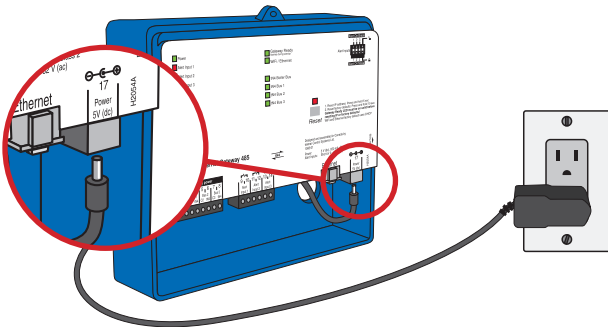

## 4. Connect Power



## 5. Status LEDs

	Gateway Ready
	WiFi / Ethernet

- Gateway Ready on solid
- WiFi / Ethernet on solid

## 6. Web Browser



## 7. Login

Set DIP switch to Unlock  
Default login: installer  
Default password: tekmar



## 8. Click "Configuration"

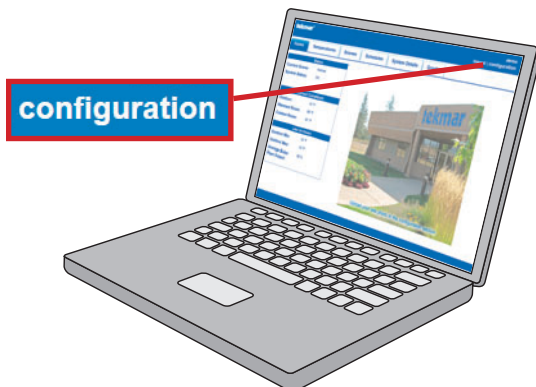

## 9. Click “Network”

Home | Temperatures | Scenes | Schedules | System Details | Graphs

Configuration  
Job Site | General | Areas | Devices | Scenes | Users | Email | Alerts | Software | History | **Network**

## 10. Ethernet Option

Home | Temperatures | Scenes | Schedules | System Details | Graphs

Configuration  
Job Site | General | Areas | Devices | Scenes | Users | Email | Alerts | Software | History | **Network**

**Network Configuration**

Ethernet | **WiFi** | DNS/Port

DHCP: Enabled  Disabled

IP Address: 192.168.0.2

Subnet Mask: 255.255.255.0

Gateway: 192.168.0.1

- Ethernet Tab**
- A. Select DHCP Disabled radio button
  - B. Enter Local Area Network static IP address example: 192.168.0.2
  - C. Subnet mask example: 255.255.255.0
  - D. Router example: 192.168.0.1
  - E. Power the router off, then power back on

## 11. WiFi Option

Configuration  
Job Site | General | Areas | Devices | Scenes | Users | Email | Alerts | Software | History | **Network**

**Network Configuration**

Ethernet | **WiFi** | DNS/Port

Status: Connected to TP-LINK\_6CD356 on 192.168.0.101 (Please remove ethernet cable.)

Network: TP-LINK\_6CD356

Password: ●●●●●●●●

Select a Network

- TP-LINK\_6CD356
- tekmar-GUEST-02
- HP-Print-80-tekmar-GUEST-print

Connect | Scan

- WiFi Network Tab**
- A. Scan and select WiFi network.
  - B. Enter WiFi password.

Configuration  
Job Site | General | Areas | Devices | Scenes | Users | Email | Alerts | Software | History | **Network**

**Network Configuration**

Ethernet | **WiFi** | DNS/Port

Status: Connected to TP-LINK\_6CD356 on 192.168.0.2 (Please

Network | **TCP/IP**

DHCP: Enabled  Disabled

IP Address: 192.168.0.2

Subnet Mask: 255 255 255 0

Gateway: 192.168.0.1

- WiFi TCP/IP Tab**
- C. Select DHCP Disabled radio button
  - D. Enter Local Area Network static IP address example: 192.168.0.2
  - E. Subnet mask example: 255.255.255.0
  - F. Router example: 192.168.0.1
  - G. Unplug Ethernet cable.
  - H. Power the router off, then power back on

## 12. Dynamic DNS

- <http://no-ip.com>
- Create account
- Download and install Dynamic Update Client (DUC) to any computer or router on the LAN.

## 13. Install In Mechanical Room

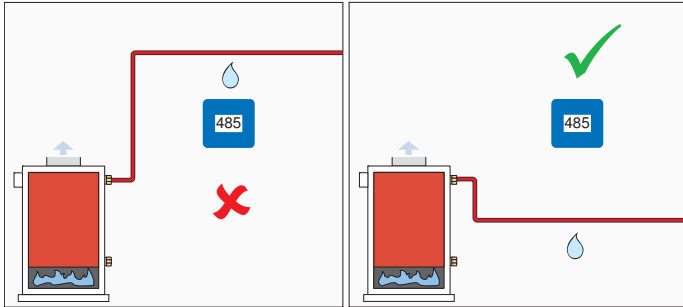

## 14. Wire tN4 Bus

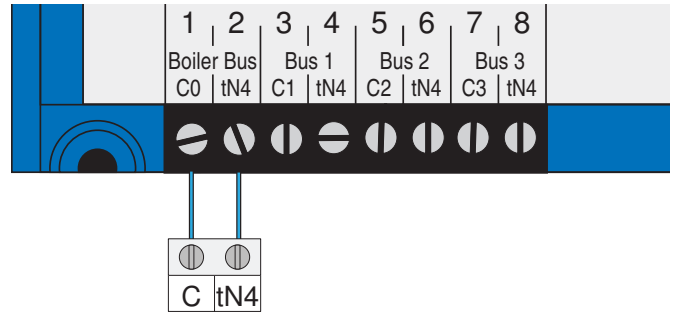

## 15. Reconnect Ethernet

- Only applies to wired Ethernet connections
- Not applicable for WiFi connections

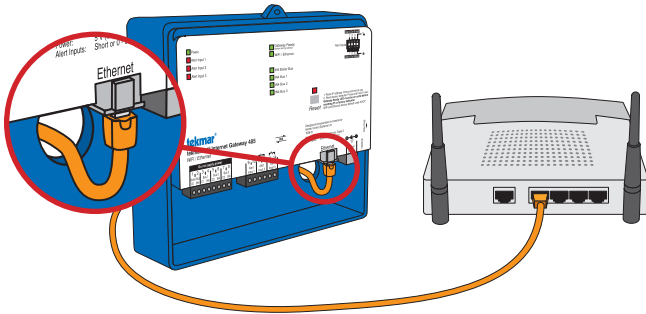

## 16. Reconnect Power

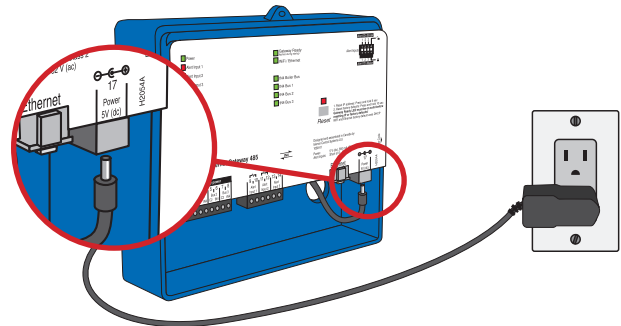

## 17. Login

### Inside building LAN

<http://tekmarginetway.local>

### Outside building on Internet

Enter no-ip.com hostname

