

Engineering Specification

Job Name _____

Contractor _____

Job Location _____

Approval _____

Engineer _____

Contractor's P.O. No. _____

Approval _____

Representative _____

Colt™ Series C500 (Colt 500), C500N (Colt 500N), C500Z (Colt 500Z)

Reduced Pressure Detector Assemblies

Sizes: 2½" – 10"

The Colt C500, C500N, C500Z Reduced Pressure Detector Assemblies are designed to protect drinking water supplies from dangerous cross-connections in accordance with national plumbing codes and water authority requirements for health-hazard non-potable service applications such as irrigation, fire line, or industrial processing. The Colt C500, C500N, C500Z are used to monitor unauthorized use of water from the fire protection system.

Features

- Extremely Compact Design
- 70% Lighter than Traditional Designs
- 304 (Schedule 40) Stainless Steel Housing & Sleeve
- Groove Fittings Allow Integral Pipeline Adjustment
- Patented Link Check Provides Lowest Pressure Loss
- Unmatched Ease of Serviceability
- Replaceable Check Disc Rubber
- Available with Grooved Butterfly Valve Shutoffs
- Bottom Mounted Cast Stainless Steel Relief Valve
- Metered Bypass to Detect Leakage or Theft of Water from the Fire Sprinkler System

Specifications

The Colt C500, C500N, C500Z Reduced Pressure Detector Assemblies shall consist of two independent Link Check modules, a differential pressure relief valve located between and below the two modules, two drip tight shutoff valves, and required test cocks. Link Check modules and relief valve shall be contained within a sleeve accessible single housing constructed from 304 (Schedule 40) stainless steel pipe with groove end connections. Link Checks shall have reversible elastomer discs and in operation produce drip tight closure against the reverse flow of liquid caused by backpressure or backsiphonage. The bypass assembly consists of a meter registering either gallon or cubic measurements, a reduced pressure zone assembly and required test cocks. Assembly shall be Colt C500, C500N, C500Z as manufactured by the Ames Fire & Waterworks.

C500N OSY
(Colt 500N GV)

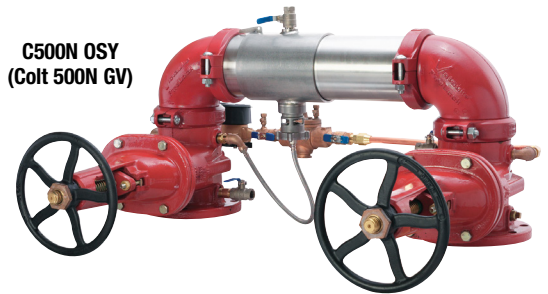

C500 OSY
(Colt 500 GV)

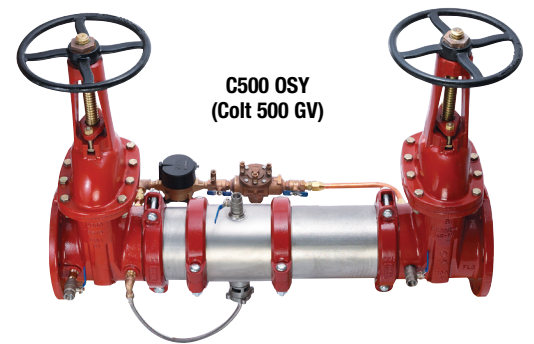

WARNING

It is illegal to use this product in any plumbing system providing water for human consumption, such as drinking or dishwashing, in the United States. Before installing standard material product, consult your local water authority, building and plumbing codes.

NOTICE

The information contained herein is not intended to replace the full product installation and safety information available or the experience of a trained product installer. You are required to thoroughly read all installation instructions and product safety information before beginning the installation of this product.

Ames Fire & Waterworks product specifications in U.S. customary units and metric are approximate and are provided for reference only. For precise measurements, please contact Ames Fire & Waterworks Technical Service. Ames Fire & Waterworks reserves the right to change or modify product design, construction, specifications, or materials without prior notice and without incurring any obligation to make such changes and modifications on Ames Fire & Waterworks products previously or subsequently sold.

AMES
 FIRE & WATERWORKS
A WATTS Brand

Configurations

- Horizontal
- “Z” pattern horizontal
- “N” pattern horizontal

Materials

- Housing & Sleeve: 304 (Schedule 40) Stainless Steel
- Elastomers: EPDM, Silicone and Buna ‘N’
- Link Checks: Noryl®, Stainless Steel
- Check Discs: Reversible Silicone or EPDM
- Test Cocks: Lead Free* Bronze Body
- Pins & Fasteners: 300 Series Stainless Steel
- Springs: Stainless Steel

*The wetted surface of this product contacted by consumable water contains less than 0.25% of lead by weight.

Pressure – Temperature

Temperature Range: 33°F – 140°F (0.5°C – 60°C)

Maximum Working Pressure: 175 psi (12.1 bar)

Available Models

Suffix:

OSY — UL/FM outside stem and yoke resilient seated gate valves

BFG — UL/FM grooved gear operated butterfly valves w/ tamper switch

*OSY FxG — Flanged inlet gate connection and grooved outlet gate connection

*OSY GxG — Grooved inlet gate connection and flanged outlet gate connection

*OSY GxG — Grooved inlet gate connection and grooved outlet gate connection

Available with grooved NRS gate valves — consult factory*

Post indicator plate and operating nut available — consult factory*

*Consult factory for dimensions

Dimensions – Weights

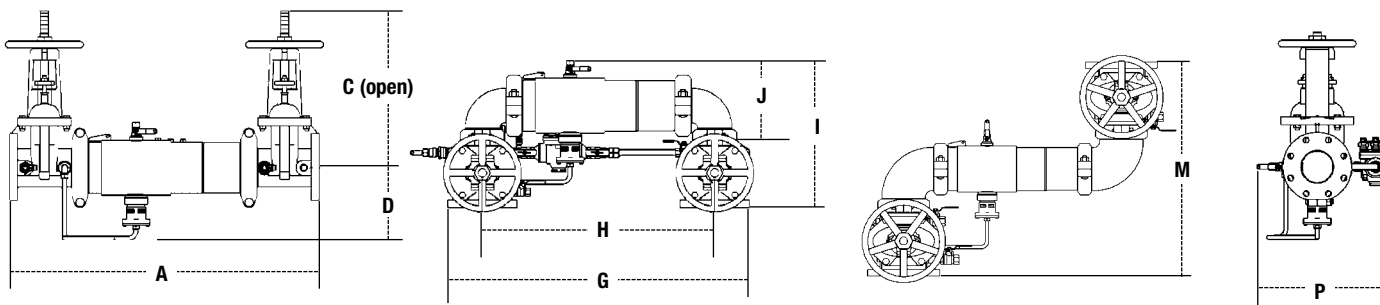

C500, C500N, C500Z

SIZE	DIMENSIONS												WEIGHT									
	A		C (OSY)		D		G		H		I		J		M		P		C500		C500N	
in.	in.	mm	in.	mm	in.	mm	in.	mm	in.	mm	in.	mm	in.	mm	in.	mm	in.	mm	lbs.	kgs.	lbs.	kgs.
2½	30¾	781	16⅞	416	6½	165	29¼	738	21½	546	15½	393	8⅜	223	21¼	540	13⅜	335	118	54	126	57
3	31¾	806	18⅞	479	6⅞	170	30¼	768	22¼	565	17⅞	435	9⅞	233	23	584	14½	368	134	61	147	67
4	33¾	857	22¼	578	7	178	35⅝	905	23½	597	18½	470	9⅞	252	26¼	667	15⅜	386	164	74	187	85
6	43½	1105	30⅞	765	8½	216	44¾	1137	33¼	845	23⅜	589	13⅞	332	34¼	870	19	483	276	125	317	144
8	49¾	1264	37¼	959	9⅞	246	54⅞	1375	40⅞	1019	27⅞	697	15⅞	399	36⅞	937	21⅞	538	441	200	516	234
10	57¾	1467	45¾	1162	11⅞	285	66	1676	49½	1257	32½	826	17⅞	440	44½	1124	24	610	723	328	893	405

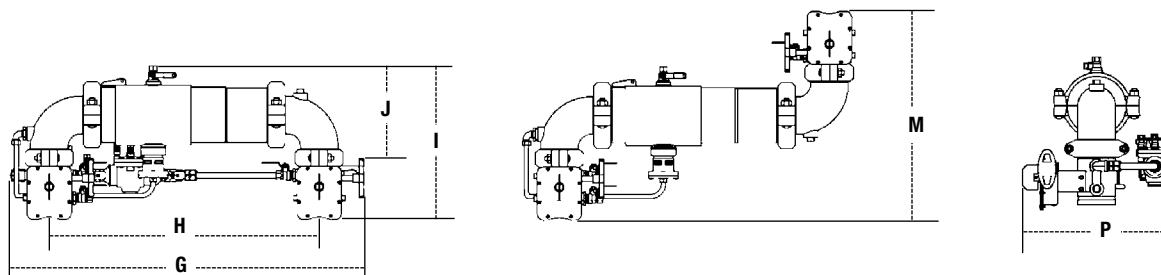

C500NBFG/C500ZBFG

SIZE	DIMENSIONS												WEIGHT			
	G		H		I		J		M		P		C500BFG			
in.	in.	mm	in.	mm	in.	mm	in.	mm	in.	mm	in.	mm	lbs.	kgs.		
2½	32½	826	23	584	15½	394	9½	241	19¾	502	15⅜	402	81	37		
3	34	864	24	610	16⅞	414	10⅞	256	21¼	540	16⅞	410	84	38		
4	35⅞	905	25½	648	17⅞	437	10⅞	279	23½	597	16⅞	422	101	46		
6	46½	1181	35¼	895	20½	521	13½	343	27¼	692	19	483	174	79		

Noryl® is a registered trademark of SABIC Innovative Plastics™.

Approvals

- Approved by the Foundation for Cross-Connection Control and Hydraulic Research at The University of Southern California (FCCCHR-USC.)
(Excluding 6" 'Z' & 10" 'N' and 'Z' configurations)
- AWWA C511-97



For additional approval information please contact the factory or visit our website at www.amesfirewater.com

Capacity

UL/FM Certified Flow Characteristics

N&Z Flow characteristics collected using butterfly shutoff valves.

Flow capacity chart identifies valve performance based upon rated water velocity up to 25fps

- Service Flow is typically determined by a rated velocity of 7.5fps based upon schedule 40 pipe.
- Rated Flow identifies maximum continuous duty performance determined by AWWA.
- UL Flow Rate is 150% of Rated Flow and is not recommended for continuous duty.
- AWWA Manual M22 [Appendix C] recommends that the maximum water velocity in services be not more than 10fps.

— Horizontal — N - Pattern - - - - Z - Pattern

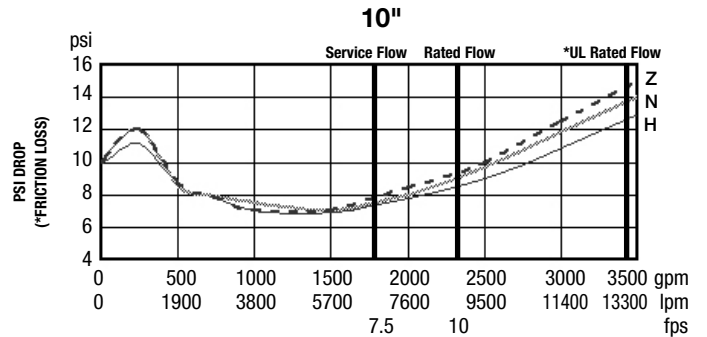
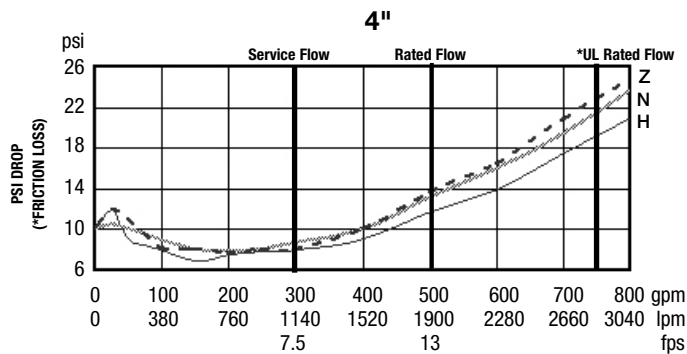
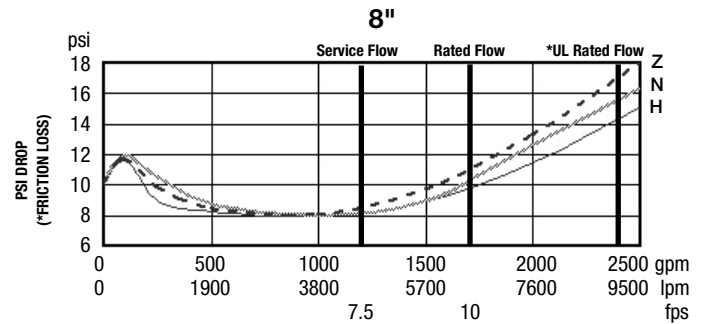
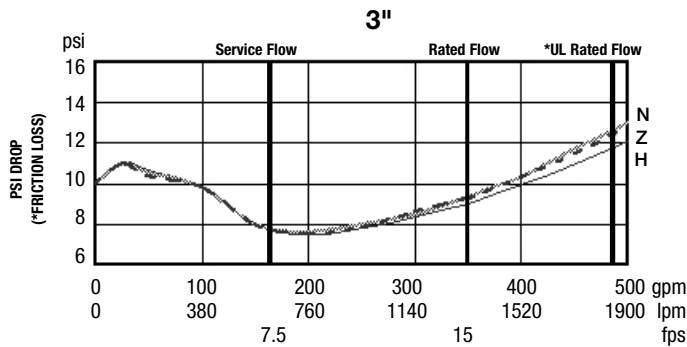
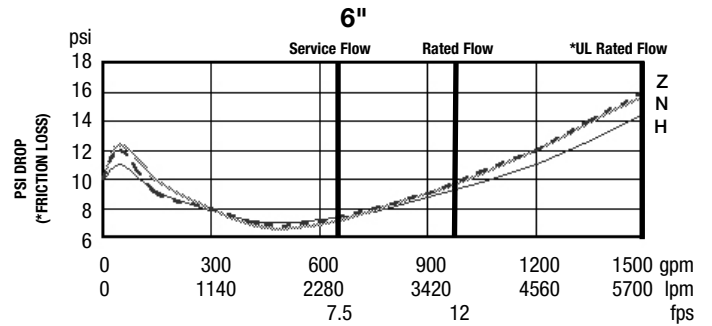
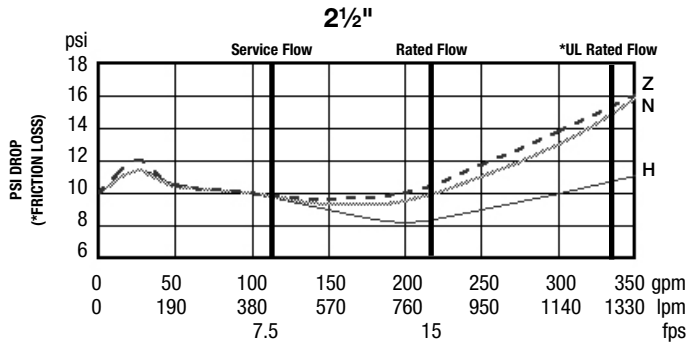

NOTICE

Inquire with governing authorities for local installation requirements



A WATTS Brand