

# Engineering Specification

Job Name \_\_\_\_\_

Contractor \_\_\_\_\_

Job Location \_\_\_\_\_

Approval \_\_\_\_\_

Engineer \_\_\_\_\_

Contractor's P.O. No. \_\_\_\_\_

Approval \_\_\_\_\_

Representative \_\_\_\_\_

Tag \_\_\_\_\_

## TD-300 Elevator Drain Specification

Watts TD-300 Elevator Drain with 11 1/2"(292) wide x (specify) long 12 ga. Type 304 stainless steel body, ADA compliant heel proof stainless steel grating with open area of 65 sq. in. per linear foot, grating secured with vandal proof stainless steel screws, and 4"(102) no hub center outlet.

Lengths 36"(914) or greater comply with 2018 International Building Code 3007.3 and 3008.3, 2013 California Building Code 403.6.1, 403.6.2, 3007.4, 3008.4, and San Francisco Fire Code 511.1.4 for a flow rate of 100 GPM.

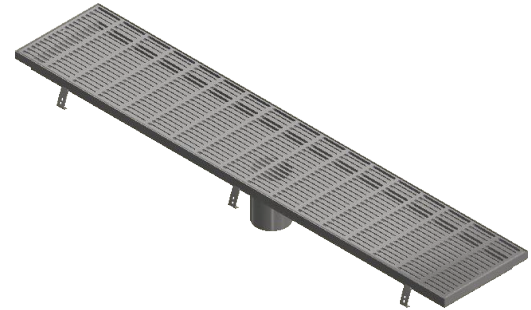

Model Number		
Suffix	Description	
TD-336	36"(914) Length	<input type="checkbox"/>
TD-342	42"(1067) Length	<input type="checkbox"/>
TD-348	48"(1219) Length	<input type="checkbox"/>
TD-360	60"(1524) Length	<input type="checkbox"/>

Options		
Suffix	Description	
-06	6"(152) No Hub Outlet	<input type="checkbox"/>
-Q	Special Length	<input type="checkbox"/>

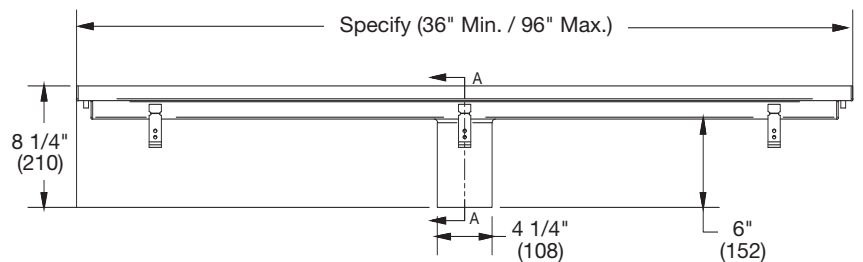
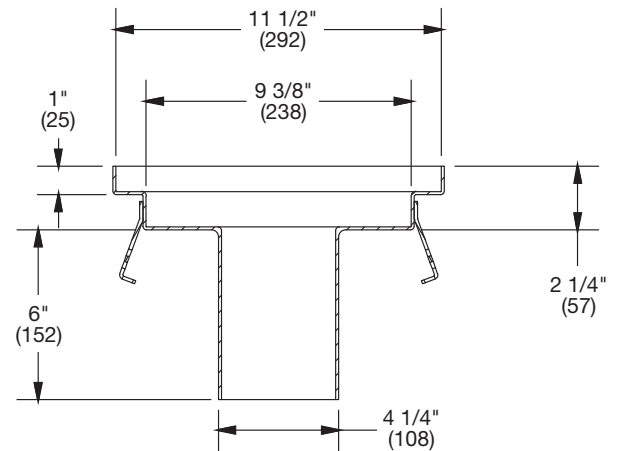

### NOTICE

The information contained herein is not intended to replace the full product installation and safety information available or the experience of a trained product installer. You are required to thoroughly read all installation instructions and product safety information before beginning the installation of this product.

Watts product specifications in U.S. customary units and metric are approximate and are provided for reference only. For precise measurements, please contact Watts Technical Service. Watts reserves the right to change or modify product design, construction, specifications, or materials without prior notice and without incurring any obligation to make such changes and modifications on Watts products previously or subsequently sold.



**USA:** T: (800) 338-2581 • F: (828) 248-3929 • Watts.com  
**Canada:** T: (888) 208-8927 • F: (905) 481-2316 • Watts.ca  
**Latin America:** T: (52) 55-4122-0138 • Watts.com