

## For Commercial Applications

Job Name \_\_\_\_\_

Contractor \_\_\_\_\_

Job Location \_\_\_\_\_

Approval \_\_\_\_\_

Engineer \_\_\_\_\_

Contractor's P.O. No. \_\_\_\_\_

Approval \_\_\_\_\_

Representative \_\_\_\_\_

Tag \_\_\_\_\_

# SI-740-L

## Sediment & Hair Interceptor

### Specification

Watts SI-740-L floor mounted or recessed epoxy coated steel large capacity sediment interceptor with gasketed epoxy coated steel skid-proof cover secured with hex head center bolt, removable stainless steel dual chamber basket, and 2"(51) no hub (standard) connections. Maximum flow rate 30 GPM.

**Note:** SI-740-L requires 17"(432) clearance above cover to remove sediment basket.

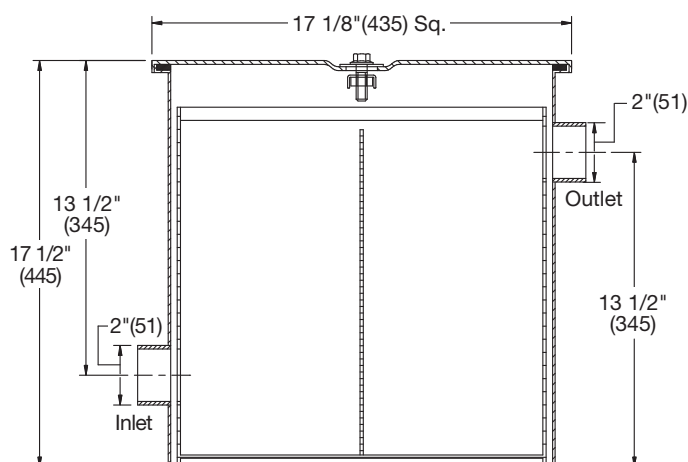

Pipe Size (Select One)		
Suffix	Description	
2	2"(51) Pipe Size	<input type="checkbox"/>
3	3"(76) Pipe Size	<input type="checkbox"/>
4	4"(102) Pipe Size	<input type="checkbox"/>

Options (Select One or More)		
Suffix	Description	
-E	Extension	<input type="checkbox"/>
-SS	All Stainless Steel	<input type="checkbox"/>
-THD	IPS Threaded Connections	<input type="checkbox"/>
-US	Buy American Compliant	<input type="checkbox"/>

### Approvals



### NOTICE

The information contained herein is not intended to replace the full product installation and safety information available or the experience of a trained product installer. You are required to thoroughly read all installation instructions and product safety information before beginning the installation of this product.

Watts product specifications in U.S. customary units and metric are approximate and are provided for reference only. For precise measurements, please contact Watts Technical Service. Watts reserves the right to change or modify product design, construction, specifications, or materials without prior notice and without incurring any obligation to make such changes and modifications on Watts products previously or subsequently sold.



**USA:** T: (800) 338-2581 • F: (978) 975-8350 • Watts.com

**Canada:** T: (905) 332-4090 • F: (905) 332-7068 • Watts.ca

**Latin America:** T: (52) 81-1001-8600 • Watts.com

ES-WD-SI-740-L-USA 1843

© 2018 Watts