

For Residential Applications

Job Name _____

Contractor _____

Job Location _____

Approval _____

Engineer _____

Contractor's P.O. No. _____

Approval _____

Representative _____

LEAD FREE*

Series LFN250 Iron Body Water Pressure Reducing Valves**

Sizes: 1/2" – 3/4"

Series LFN250 Iron Body Water Pressure Reducing Valves are designed to reduce incoming water pressure to a sensible level to protect plumbing system components and reduce water consumption. This series is suitable for water supply pressures up to 250psi (17.2 bar) and may be adjusted from 25 – 75psi (172 – 517 kPa). The standard setting is 50psi (345 kPa). All parts are quickly and easily serviceable without removing the valve from the line. The optional bypass feature permits the flow of water back through the valve into the main when pressures, due to thermal expansion on the outlet side of the valve, exceed the pressure in the main supply. The LFN250 features Lead Free* construction to comply with Lead Free* installation requirements.

Features

- Integral strainer
- Unitized construction for ease of maintenance
- High temperature resisting diaphragm for hot or cold water
- All working parts easily and quickly serviceable without removing the valve from the line
- Optional bypass feature controls thermal expansion pressure***

Models

LFN250 NPT threaded female inlet x NPT female outlet

LFN250B NPT threaded female inlet x NPT female outlet with thermal expansion bypass feature

Note: Cast iron body regulators are not intended for buried or pit services.

Specifications

A Water Pressure Reducing Valve and strainer shall be installed on the water service pipe near its entrance to the building where supply main pressure exceeds 60psi (413 kPa) to reduce it to 50psi (345 kPa) or lower. Provision shall be made to permit the bypass flow of water back through the valve into the main when pressures, due to thermal expansion on the outlet side of the valve, exceed the pressure in the main supply. Pressure reducing valves with built-in bypass check valves and integral strainer will be acceptable. Valve shall be a Watts Series LFN250.

Watts product specifications in U.S. customary units and metric are approximate and are provided for reference only. For precise measurements, please contact Watts Technical Service. Watts reserves the right to change or modify product design, construction, specifications, or materials without prior notice and without incurring any obligation to make such changes and modifications on Watts products previously or subsequently sold.



Materials

Body: Iron
Seat: Stainless steel
Integral Strainer: Stainless steel
Stem: Lead Free* brass
Disc: Lead Free* brass

Pressure – Temperature

Temperature Range: 33°F – 160°F (0.5°C – 71°C)
Maximum Working Pressure: 250psi (17.2 bar)
Adjustable Reduced Pressure Range: 25 – 75psi (172 – 517 kPa)
Standard Reduced Pressure Setting: 50psi (345 kPa)

Dimensions – Weights

SIZE	DIMENSIONS				WEIGHT			
	A		B		C			
in.	in.	mm	in.	mm	in.	mm	lbs.	kgs
1/2	4	102	1 5/8	41	3 7/8	98	2.5	1.1
3/4	4 5/16	110	1 3/8	35	5	127	3.5	1.6

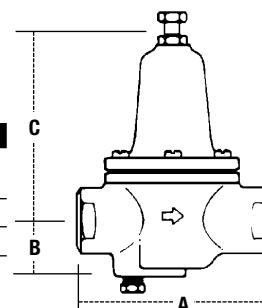

*The wetted surface of this product contacted by consumable water contains less than 0.25% of lead by weight.

**A water saving test program concluded that reducing the supply pressure from 80 – 50psi (551 – 345 kPa) resulted in a water savings of 30%.

***The bypass feature will not prevent the pressure relief valve from opening on the hot water supply system with pressure above 150psi (10.3 bar).

NOTICE

The information contained herein is not intended to replace the full product installation and safety information available or the experience of a trained product installer. You are required to thoroughly read all installation instructions and product safety information before beginning the installation of this product.

NOTICE

Inquire with governing authorities for local installation requirements

USA: T: (978) 689-6066 • F: (978) 975-8350 • Watts.com

Canada: T: (905) 332-4090 • F: (905) 332-7068 • Watts.ca

Latin America: T: (52) 81-1001-8600 • Watts.com